

Off-Road Winch DU-9000A

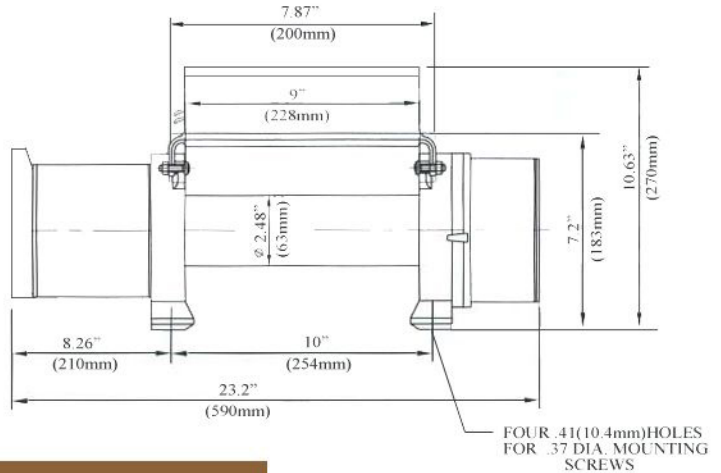

Specifications

Max line pull

9000 lbs (4070 kgs)

Rated line pull

9000 lbs (4070 kgs)

Weight

72.7 lbs (33kgs)

Gear reduction ratio

210:1 (12V); 210:1 (24V)

Cable (Dia X L)

Ø5/16" X 95' (Ø8mm X 29m)

Overall dimensions

23.2" X 7.1" X 10.6"
(590mm X 180mm X 270mm)

Drum size

Ø2.48" X 9" (Ø63mm X 228mm)



Exclusive Tuningparts for US Cars and Offroad vehicles

Line Pull kgs. (lbs.)	Line Speed m/min. (ft./min.)	Motor Current	PULL BY LAYER layer/kgs. (lbs)
0	11.58 (38.0)	70 amp	1/4082 (9000)
907 (2000)	4.39 (14.4)	180 amp	2/3715 (8190)
1814 (4000)	3.35 (11.0)	255 amp	3/3402 (7500)
2722 (6000)	2.64 (8.67)	330 amp	4/3180 (7010)
3629 (8000)	2.10 (6.88)	415 amp	5/2980 (6570)
4082 (9000)	1.94 (6.38)	460 amp	



Exclusive Tuningparts for US Cars and Offroad vehicles

- (1) SUPER POWER (3.6HP),HEAVY DUTY PERMANENT MAGNETIC TYPE MOTOR, HIGH AMPERE RESISTANCE,WITH HUGE OUTPUT STRENGTH.
- (2) ZINC ALLOY GEAR BOX, 3-STAGE PLANETARY GEAR SPEED REDUCE SYSTEM WITH REDUCE RATIO 210:1, SUPER TORQUE STRENGTH
(EACH STAGE OF SPEED REDUCE SYSTEM COMPOSED OF 3 PCs
OF GEARS, EACH PIECE OF GEAR IS PRODUCED BY HIGH PRESSURE PROCESS WITH HIGH PRECISION CHARACTER AND HIGH WORKING CAPACITY).
- (3) ALUMINUM ALLOY MAIN UNIT BASE AND HIGH TENACITY SUPPORT BASE CAN MAKE WINCH TO OUTPUT THE MAXIMUM STRENGTH STABLY.
- (4) MECHANICAL SAFE BRAKE SYSTEM, DURING THE MORE BIG LOADING STATUS, THE MORE EXCELLENT EFFECT COMES FROM AUTOMATIC MECHANICAL BRAKE UNIT.
- (5) CONE TYPE DIFFERENT MOTION CLUTCH CAN MAKE GEAR BOX REMOVE FROM MAIN UNIT, THEN STEEL WIRE WILL BE PULLED OUT BY HAND, IT IS VERY CONVENIENT AND FAST FOR OPERATION.
- (6) 4-WAY STEEL WIRE GUIDE WHEEL, TO MAKE STEEL WIRE INPUT COILED FROM MULTIDIRECTIONS.
- (7) SEPARATED SOCKET TYPE CONTROL SWITCH.
- (8) HIGH STRENGTH STEEL WIRE AND CONVENIENT REPLACEABLE CLEVIS HOOK.
- (9) HIGH PERFORMANCE,MULTIFUNCTIONS,VERSATILE.